

Oberlichtbeschlag PT 30

Art. Nr. 03.120 (10 mm Glas)
 Art. Nr. 03.282 (15/19 mm Glas)
 inkl. Einsatz mit Zapfen Ø15 mm (Art. Nr. 03.125)

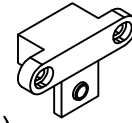

Art. Nr. 03.420 (10 mm Glas)
 Art. Nr. 03.482 (15/19 mm Glas)
 inkl. Anschlageseinsatz (Art. Nr. 03.127)



Art. Nr. 03.421 (10 mm Glas)
 Art. Nr. 03.484 (15/19 mm Glas)
 inkl. Blindeinsatz (Art. Nr. 03.126)

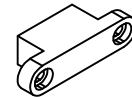

Art. Nr. 01.900 extra Zwischenlage (8 mm Glas)
 Art. Nr. 01.901 extra Zwischenlage (12 mm Glas)

Glasbearbeitung siehe Detail 03-031

10 (8/12/15/19)

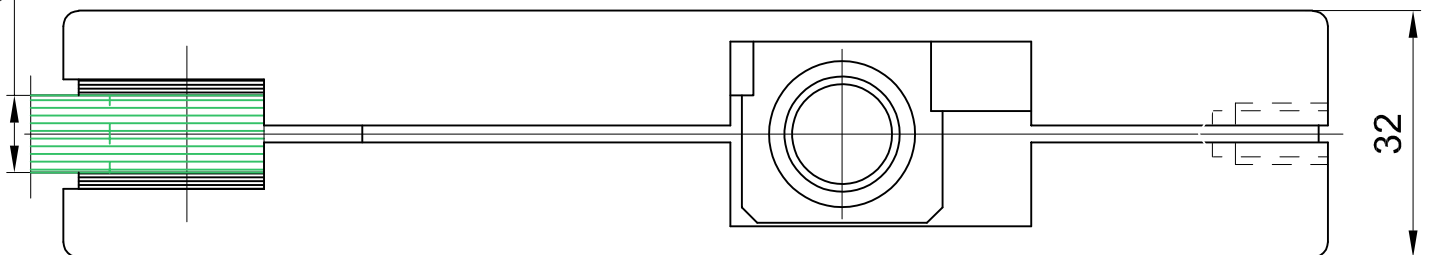

T:\SHARED\IDEBFN\KONSTRUKTION_INTERNA\DETAIL\03\03-030.DWG

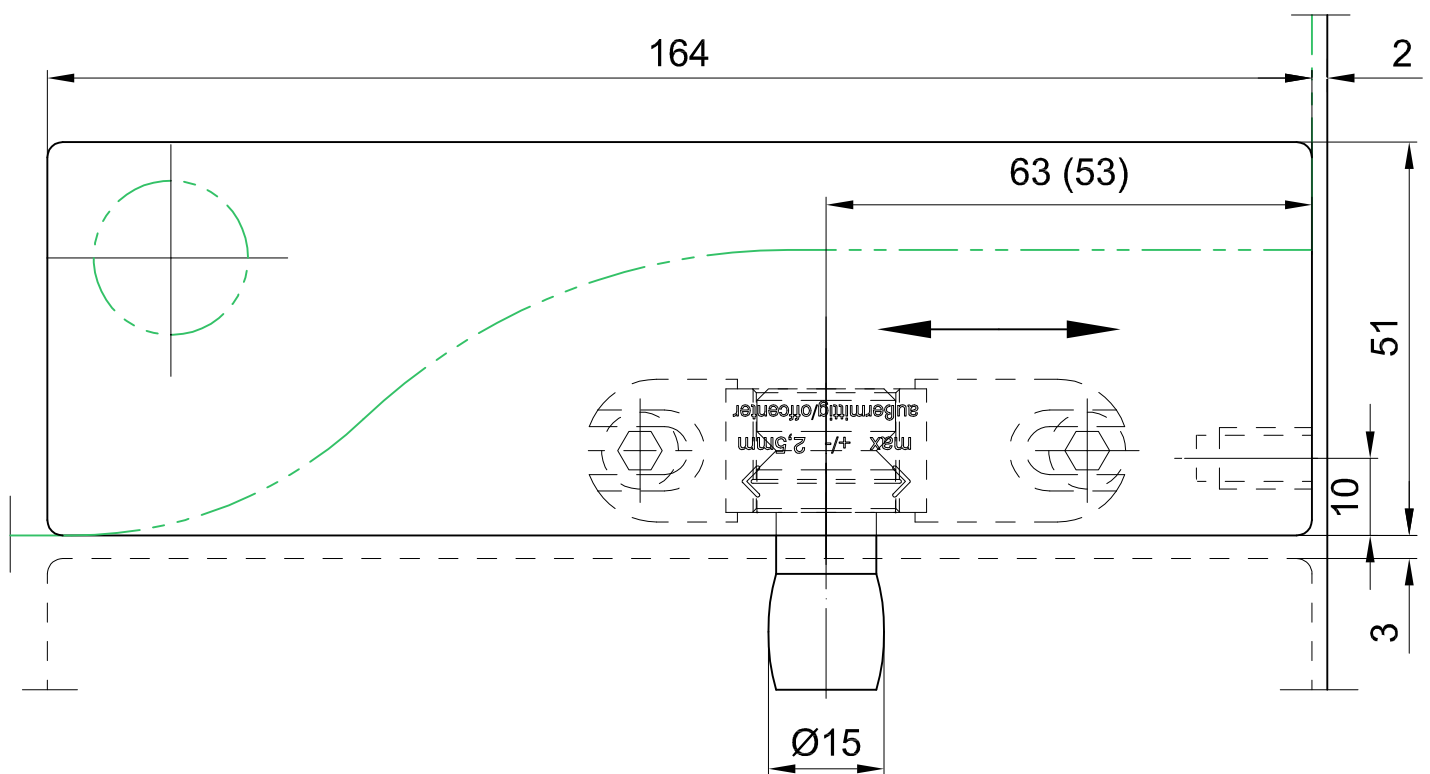

Glasbearbeitung

zu Eckbeschlägen

PT 10, 20, 22, 29, 30

